

Tilda®

Creating Memories
AUTUMN

Squirrel Pillows



Squirrel Pillow

(Brown Colourway)

If you need pillows to match the Squirrel Quilt, we've got you covered with two charming designs featuring a squirrel with the latest addition to his winter larder. This pillow has a brown Chambray background and there is a second pillow with a mustard background (see page 9). The pillow covers are made up with a button fastening at the back using pretty Tilda buttons.

Difficulty Rating **

Materials

- Fabric 1: $\frac{3}{8}$ yd (40cm) – Chambray brown (160035) (background)
- Fabric 2: $\frac{1}{8}$ yd (15cm) or a fat eighth – Harper saffron (130142)
- Fabric 3: about 9in (23cm) square – Tiny Stripe cream (160080)
- Fabric 4: one piece 1in x $1\frac{1}{4}$ in (2.5cm x 3.2cm) and one piece 4in x $1\frac{3}{4}$ in (10.2cm x 4.4cm) – Plaid stone (160079)
- Fabric 5: one piece $3\frac{1}{2}$ in (9cm) square – Evie rust (130138)
- Wadding (batting): 21in x 16in (53.5cm x 40.5cm)
- Lining fabric: 21in x 16in (53.5cm x 40.5cm) (optional)
- Fabric for back of pillow: $\frac{3}{8}$ yd (40cm) – Carla saffron (130141)
- Binding fabric: $\frac{1}{4}$ yd (25cm) – Carla saffron (130141)
- Piecing and quilting threads
- Black stranded cottons (floss) for eye embroidery
- Quilter's ruler, rotary cutter and mat
- Pack of Creating Memories Buttons in Autumn, Thanksgiving and Halloween 10mm and 12mm (400064)
- Pillow pad to fit cover

Finished Size

$19\frac{1}{4}$ in x 14in (49cm x 35.5cm)

Fabric Notes

For some of the fabrics only need one or two pieces, so the exact cutting size is given in the Materials list.

General Notes

- Fabric quantities are based on a usable width of 42in (107cm), unless otherwise stated.
- Measurements are in imperial inches with metric conversions in brackets – use only *one* system throughout (preferably inches). Width measurements are generally given first.
- Press fabric before cutting and trim as needed to square up the fabric pattern/weave, using a quilting ruler to cut the top raw edge at 90 degrees to the selvages.
- Use $\frac{1}{4}$ in (6mm) seams unless otherwise instructed.
- Read all the instructions through before you start.

Pillow Layout

1 The pillow is made up of a Squirrel block and an Acorn block, with a border at each side of the pillow and at the top and bottom. See **Fig A** for the fabrics used and **Fig B** for the pillow layout.

Fig A Fabric swatches (Squirrel Pillow – brown colourway)

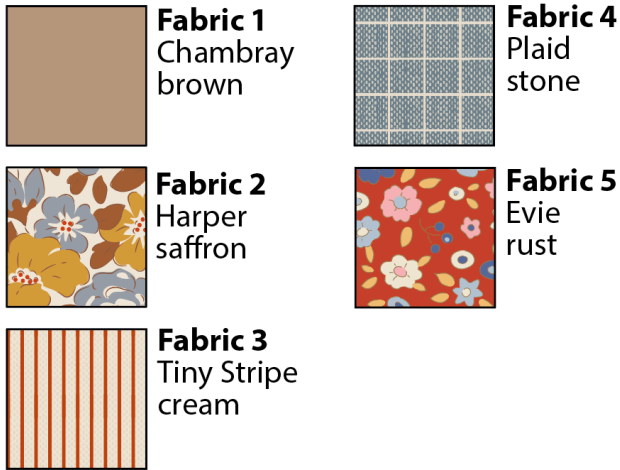
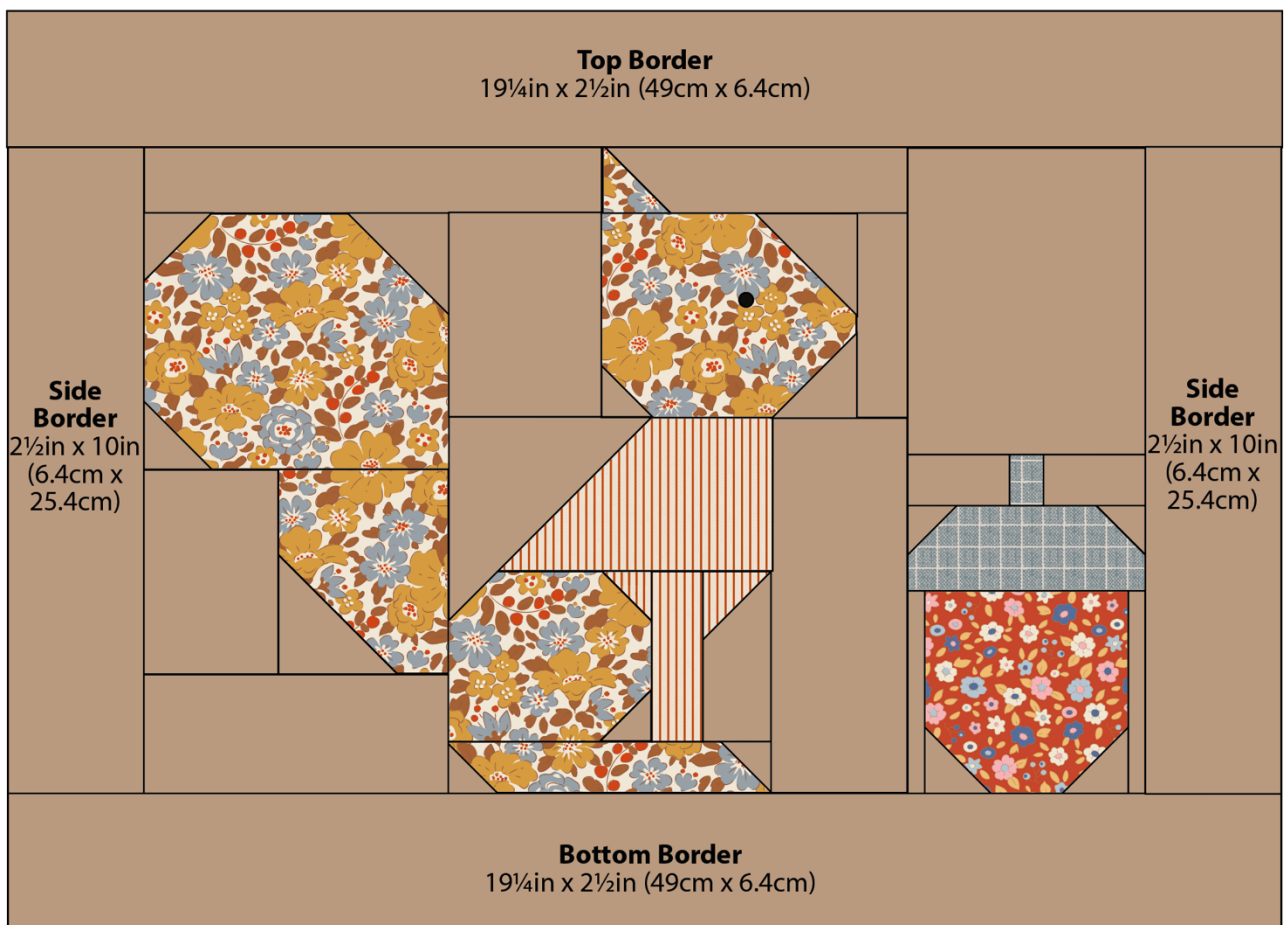

Fig B Pillow layout and cut border measurements



Cutting Out

2 From Fabric 1 cut the border strips first, cutting the following pieces (see **Fig B**).

- Side borders – two strips 2½in x 10in (6.4cm x 25.4cm).
- Top and bottom borders – two strips 19¼in x 2½in (49cm x 6.4cm).

3 For the Fabric 1 background pieces for the blocks refer to the cut measurements in **Fig C** (Squirrel) and **Fig D** (Acorn). See also **Fig B** for the exact fabric positions in the blocks.

4 For the print fabrics, follow the cut measurements in **Fig C** and **Fig D**. See also **Fig B** for the exact fabric positions in the blocks. For Fabric 4 and Fabric 5 the exact sizes needed are given in the Materials list.

5 From the fabric for the back of the pillow cut two pieces 20in x 10in (50.8cm x 25.4cm).

6 Cut the binding fabric into two 2½in (6.4cm) x width of fabric strips. Sew the strips together end to end and press seams open. Press the binding in half along the length, wrong sides together.

Fig C Cut measurements for the Squirrel block

Sizes include ¼in (6mm) seam allowances

All pieces to be cut initially as squares or rectangles

Squirrel Block: 11¾in x 10in (29.8cm x 25.4cm) unfinished

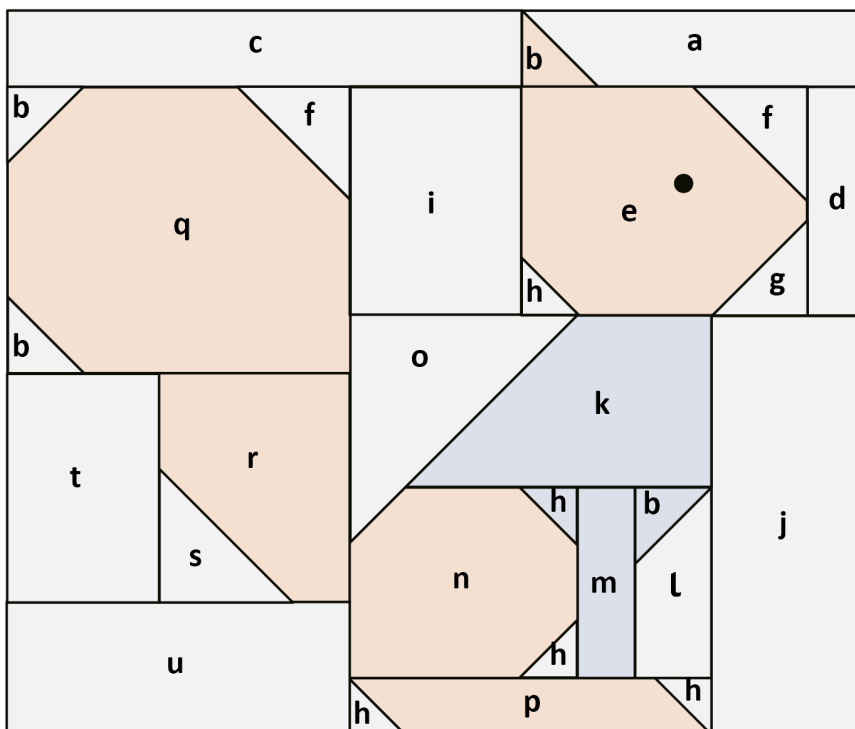

- a 5in x 1½in (12.7cm x 3.8cm)
 - b 1½in (3.8cm) square
 - c 7¼in x 1½in (18.4cm x 3.8cm)
 - d 1¼in x 3½in (3.2cm x 9cm)
 - e 4¼in x 3½in (10.8cm x 9cm)
 - f 2in (5.1cm) square
 - g 1¾in (4.4cm) square
 - h 1¼in (3.2cm) square
 - i 2¾in x 3½in (7cm x 9cm)
 - j 2½in x 6in (6.4cm x 15.2cm)
 - k 5¼in x 2¾in (13.3cm x 7cm)
 - l 1½in x 3in (3.8cm x 7.6cm)
 - m 1¼in x 3in (3.2cm x 7.6cm)
 - n 3½in x 3in (9cm x 7.6cm)
 - o 3½in (9cm) square
 - p 5¼in x 1¼in (13.3cm x 3.2cm)
 - q 5in x 4¼in (12.7cm x 10.8cm)
 - r 3in x 3½in (7.6cm x 9cm)
 - s 2¼in (5.7cm) square
 - t 2½in x 3½in (6.4cm x 9cm)
 - u 5in x 2¼in (12.7cm x 5.7cm)
- French knot eye – see instructions

Fig D Cut measurements for the Acorn block

Sizes include ¼in (6mm) seam allowances

All pieces to be cut initially as squares or rectangles

Acorn Block: 4in x 10in
(10.2cm x 25.4cm) unfinished

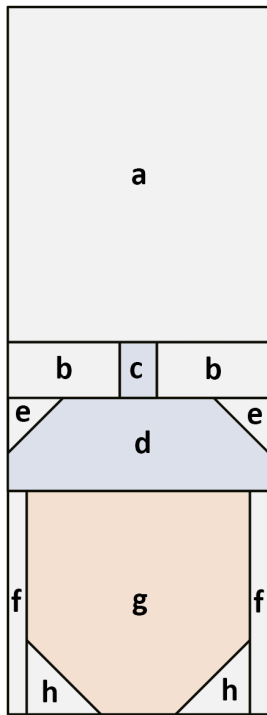

- a** 4in x 5in (10.2cm x 12.7cm)
- b** 2in x 1½in (5.1cm x 3.2cm)
- c** 1in x 1½in (2.5cm x 3.2cm)
- d** 4in x 1½in (10.2cm x 4.4cm)
- e** 1½in (3.2cm) square
- f** ¾in x 3½in (2cm x 9cm)
- g** 3½in (9cm) square
- h** 1½in (3.8cm) square

Making the Blocks

7 Apart from the block assembly, most of the piecing is to make corner triangle units and the blocks use corner triangle units in various places. The basic technique is the same regardless of the size of the pieces being sewn. **Fig E** shows the stages of creating a corner triangle. **Fig F** shows where these units occur in the blocks (outlined in blue).

The basic process of sewing a corner triangle is as follows. Place the larger piece of fabric right side up (RS). Take the small square and pencil mark a diagonal line on the wrong side (WS) of the square. Pin the square right sides together with the larger fabric piece, aligning the edges as shown in **Fig E** and with the diagonal line in the direction needed. Sew along the marked line. Trim off excess fabric ¼in (6mm) outside the sewn line and gently press the triangle outwards. Check the unit is the same size as the original larger piece of fabric, with no distortion.

Fig E Making a corner triangle unit

Fig F Units in the blocks needing corner triangles
(Outlined in blue)

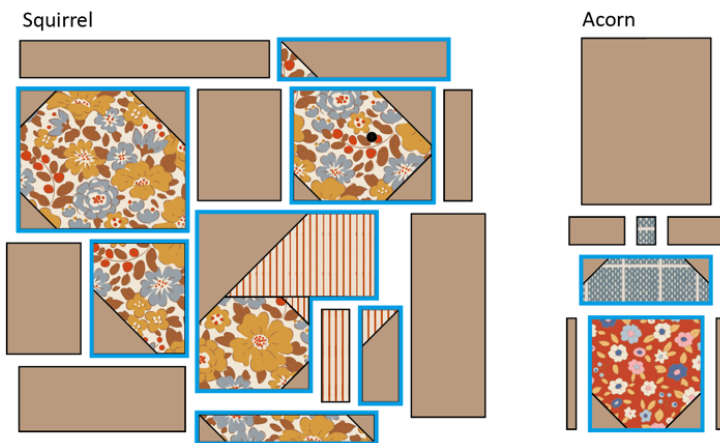

Making the Squirrel Block

8 When the pieced units have been made, a Squirrel block can be sewn together. Follow the stages shown in **Fig G**, pressing seams after each stage, pressing open or to one side. Note that in **Fig G 3**, a corner triangle needs to be created across the back of the squirrel, forming a triangle of Fabric 1 over the edges of piece **k** and piece **n**. When the assembly is finished, check the sewn block is 11 $\frac{3}{4}$ in x 10in (29.8cm x 24.5cm). Use a French knot to sew the eye, using six strands of black stranded cotton, with the thread wrapped twice around the needle.

Fig G Assembling a Squirrel block

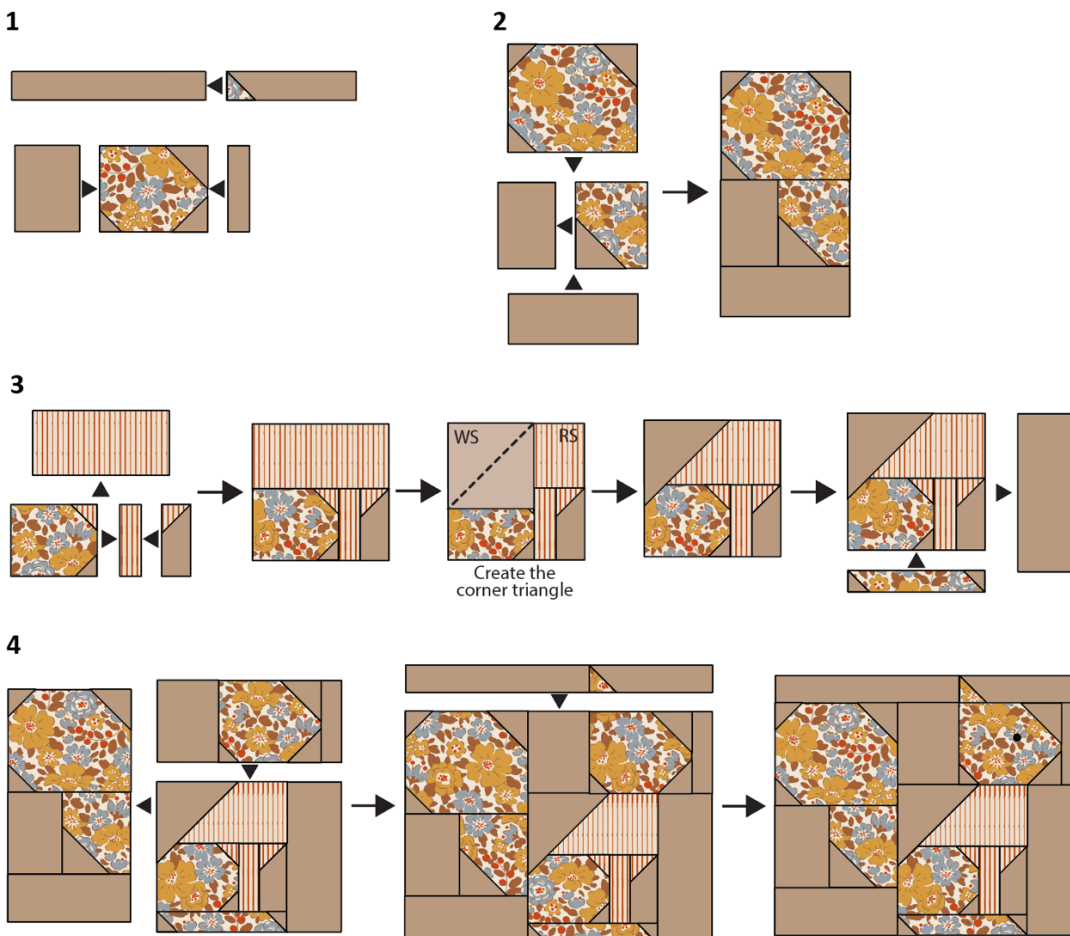

Making the Acorn Block

9 For the Acorn block, make the units that need corner triangles, as described before and then follow **Fig H** to sew the block together. Once sewn, check it is 4in x 10in (10.2cm x 25.4cm).

Fig H Assembling an Acorn block

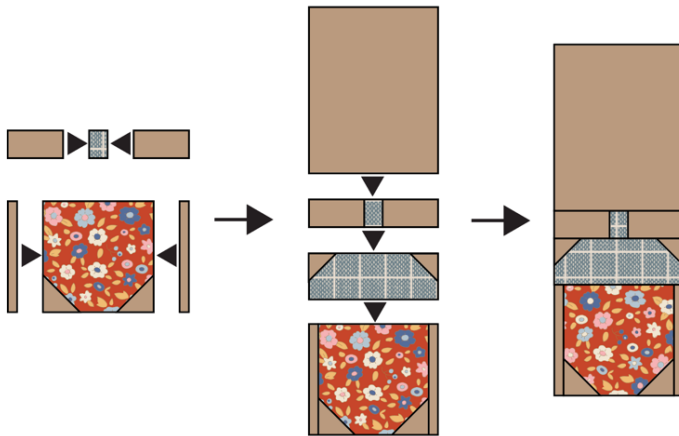

Assembling the Pillow

10 To complete the patchwork, sew the blocks together as in **Fig I**. Add the side borders to the patchwork, pressing seams out towards the border strips. Now add the top and bottom borders and press seams outwards.

Fig I Assembling the patchwork

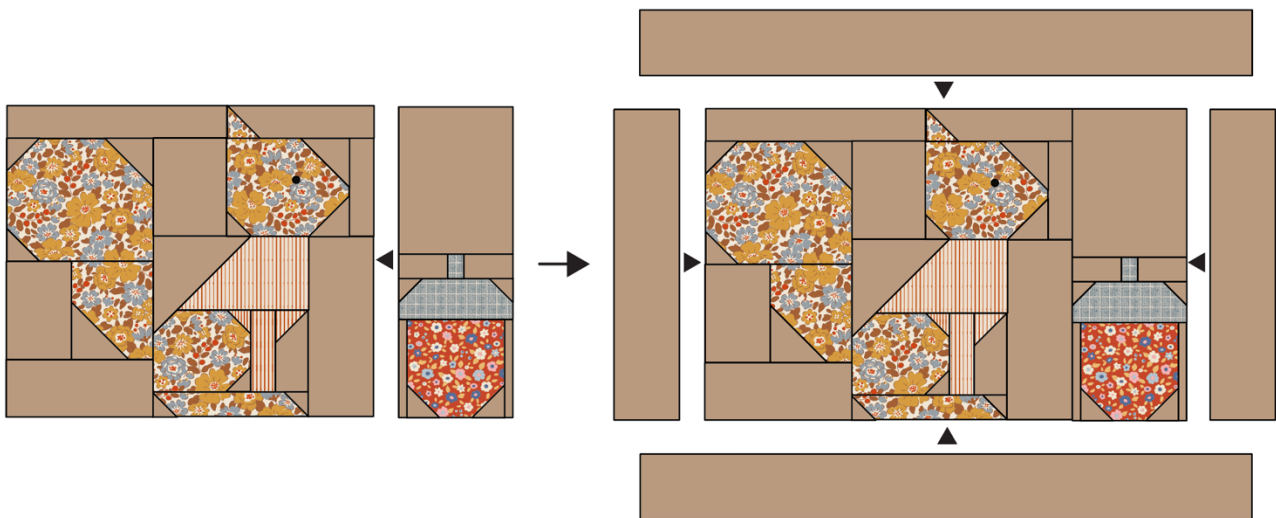

Quilting and Finishing

11 Make a quilt sandwich of the patchwork, wadding (batting) and lining fabric (if using). Quilt as desired. Trim off excess wadding and lining fabric to match the patchwork size.

12 To make up the pillow cover, take the two pieces of fabric for the cushion back and on one long edge of each piece, create a hem by turning the edge over by 1in (2.5cm), twice. Sew the seams with matching thread and press (**Fig J**). The diagram is shown in greys, so you can use the Tilda fabric and buttons suggested in the Materials list, or those of your choice.

13 For the fastening, using your sewing machine, create five equally spaced buttonholes within the hem of one of the pieces. Sew five buttons onto the other piece, matching their positions to the

buttonholes. Note: Instead of making buttonholes, you could use a hook and loop fastening, such as Velcro, to fasten the cover and sew on the buttons as a decorative feature.

14 The pillow has a bound edge, so the pieces are assembled with right sides out, as follows. On the backing, fasten the buttons into the buttonholes and place the whole piece right side down. Place the quilted patchwork on top, right side up. Make sure the outer edges of all pieces are aligned. Pin or tack (baste) the layers together and then bind as normal. As you sew the binding in place it will fix the other layers together. Press the cover and insert a pillow pad to finish.

Fig J Making up the cover

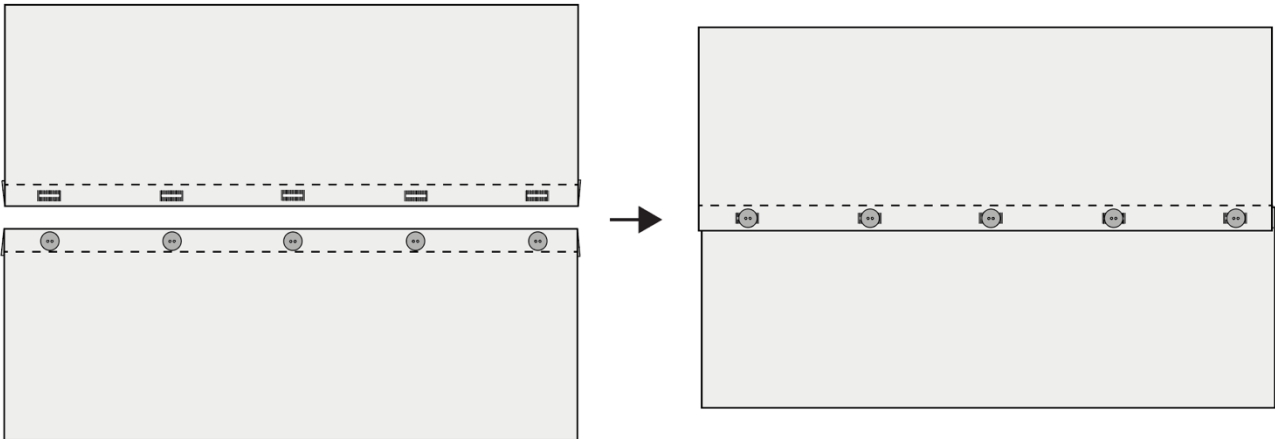

Squirrel Pillow (Mustard Colourway)

This cute squirrel seems pleased with the latest nut he's found for his winter store and the design is so charming we're sure you'll want to make the pillow to complement the Squirrel Quilt. This pillow has a mustard Chambray background and there is a second pillow with a brown background (see tildasworld.com for the brown pillow and also the quilt instructions). The pillow covers are made up with a button fastening at the back using lovely Tilda buttons to match the fabrics.

Difficulty Rating **

Materials

- Fabric 1: $\frac{3}{8}$ yd (40cm) – Chambray mustard (160042) (background)
- Fabric 2: $\frac{1}{8}$ yd (15cm) or a fat eighth – Brie brown (130137)
- Fabric 3: about 9in (23cm) square – Polka Dot ginger (160078)
- Fabric 4: one piece 1in x $1\frac{1}{4}$ in (2.5cm x 3.2cm) and one piece 4in x $1\frac{3}{4}$ in (10.2cm x 4.4cm) – Stripe toffee (160076)
- Fabric 5: one piece $3\frac{1}{2}$ in (9cm) square – Lulu saffron (130139)
- Wadding (batting): 21in x 16in (53.5cm x 40.5cm)
- Lining fabric: 21in x 16in (53.5cm x 40.5cm) (optional)
- Fabric for back of pillow: $\frac{3}{8}$ yd (40cm) – Frida brown (130143)
- Binding fabric: $\frac{1}{4}$ yd (25cm) – Frida brown (130143)
- Piecing and quilting threads
- Black stranded cottons (floss) for eye embroidery
- Quilter's ruler, rotary cutter and mat
- Pack of Creating Memories Buttons in Autumn, Thanksgiving and Halloween 10mm and 12mm (400064)
- Pillow pad to fit cover

Finished Size

$19\frac{1}{4}$ in x 14in (49cm x 35.5cm)

Fabric Notes

For some of the fabrics only need one or two pieces, so the exact cutting size is given in the Materials list.

General Notes

- Fabric quantities are based on a usable width of 42in (107cm), unless otherwise stated.
- Measurements are in imperial inches with metric conversions in brackets – use only *one* system throughout (preferably inches). Width measurements are generally given first.
- Press fabric before cutting and trim as needed to square up the fabric pattern/weave, using a quilting ruler to cut the top raw edge at 90 degrees to the selvages.
- Use $\frac{1}{4}$ in (6mm) seams unless otherwise instructed.
- Read all the instructions through before you start.

Pillow Layout

1 The pillow is made up of a Squirrel block and an Acorn block, with a border at each side of the pillow and at the top and bottom. See **Fig A** for the fabrics used and **Fig B** for the pillow layout.

Fig A Fabric swatches (Squirrel Pillow – mustard colourway)



Fig B Pillow layout and cut border measurements

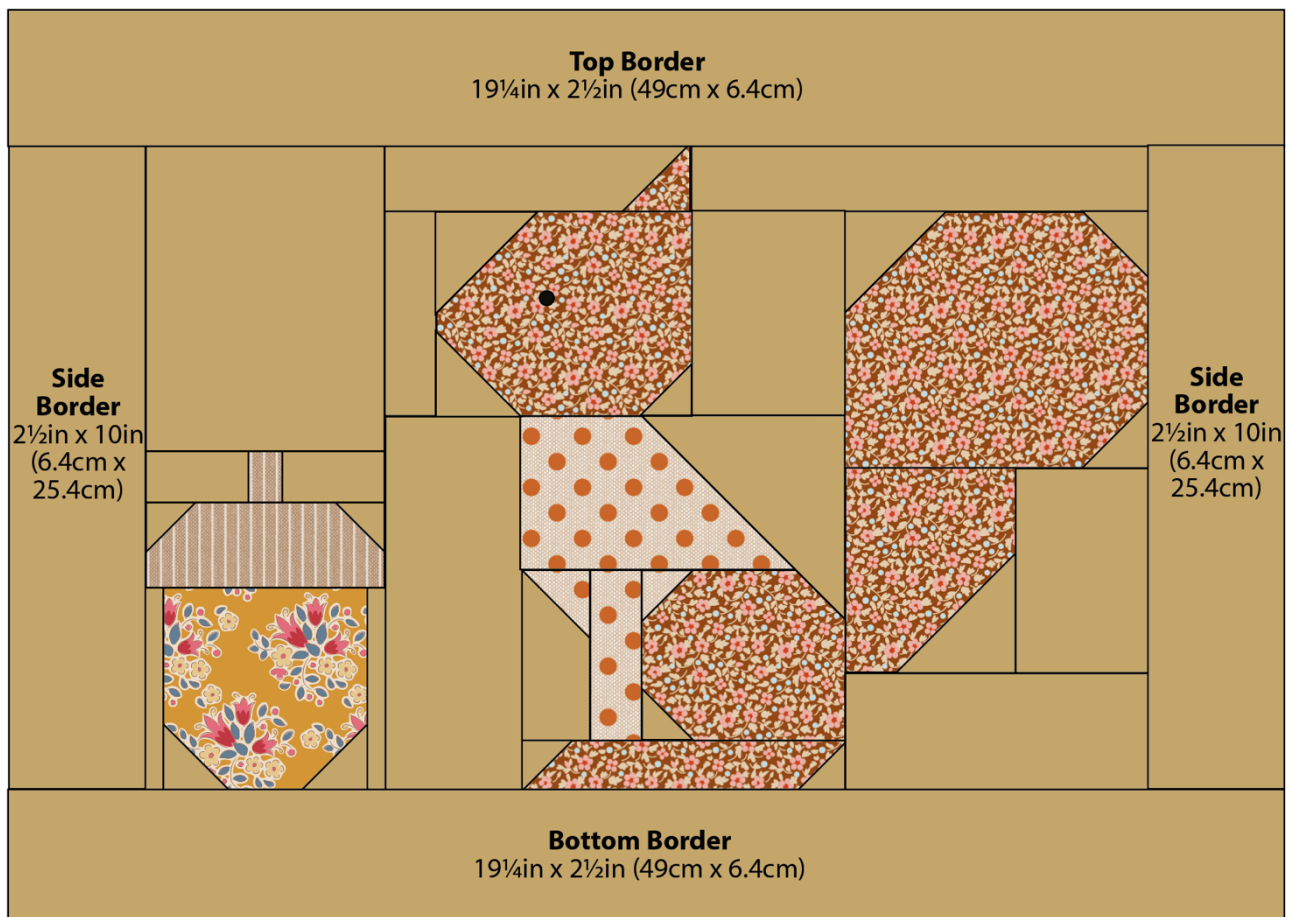

Cutting Out

2 From Fabric 1 cut the border strips first, cutting the following pieces (see **Fig B**).

- Side borders – two strips 2½in x 10in (6.4cm x 25.4cm).
- Top and bottom borders – two strips 19¼in x 2½in (49cm x 6.4cm).

3 For the Fabric 1 background pieces for the blocks refer to the cut measurements in **Fig C** (Squirrel) and **Fig D** (Acorn). See also **Fig B** for the exact fabric positions in the blocks.

4 For the print fabrics, follow the cut measurements in **Fig C** and **Fig D**. See also **Fig B** for the exact fabric positions in the blocks. For Fabric 4 and Fabric 5 the exact sizes needed are given in the Materials list.

5 From the fabric for the back of the pillow cut two pieces 20in x 10in (50.8cm x 25.4cm).

6 Cut the binding fabric into two 2½in (6.4cm) x width of fabric strips. Sew the strips together end to end and press seams open. Press the binding in half along the length, wrong sides together.

Fig C Cut measurements for the Squirrel block

Sizes include ¼in (6mm) seam allowances

All pieces to be cut initially as squares or rectangles

Squirrel Block: 11¾in x 10in (29.8cm x 25.4cm) unfinished

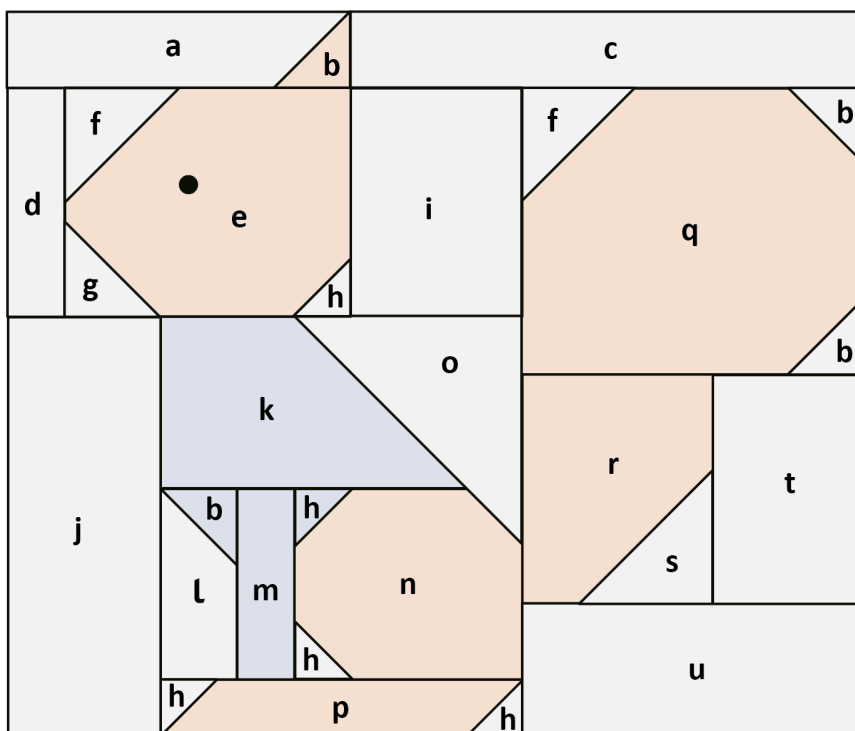

- a 5in x 1½in (12.7cm x 3.8cm)
 - b 1½in (3.8cm) square
 - c 7¼in x 1½in (18.4cm x 3.8cm)
 - d 1¼in x 3½in (3.2cm x 9cm)
 - e 4¼in x 3½in (10.8cm x 9cm)
 - f 2in (5.1cm) square
 - g 1¾in (4.4cm) square
 - h 1¼in (3.2cm) square
 - i 2¾in x 3½in (7cm x 9cm)
 - j 2½in x 6in (6.4cm x 15.2cm)
 - k 5¼in x 2¾in (13.3cm x 7cm)
 - l 1½in x 3in (3.8cm x 7.6cm)
 - m 1¼in x 3in (3.2cm x 7.6cm)
 - n 3½in x 3in (9cm x 7.6cm)
 - o 3½in (9cm) square
 - p 5¼in x 1¼in (13.3cm x 3.2cm)
 - q 5in x 4¼in (12.7cm x 10.8cm)
 - r 3in x 3½in (7.6cm x 9cm)
 - s 2¼in (5.7cm) square
 - t 2½in x 3½in (6.4cm x 9cm)
 - u 5in x 2¼in (12.7cm x 5.7cm)
- French knot eye – see instructions

Fig D Cut measurements for the Acorn block

Sizes include $\frac{1}{4}$ in (6mm) seam allowances

All pieces to be cut initially as squares or rectangles

Acorn Block: 4in x 10in
(10.2cm x 25.4cm) unfinished

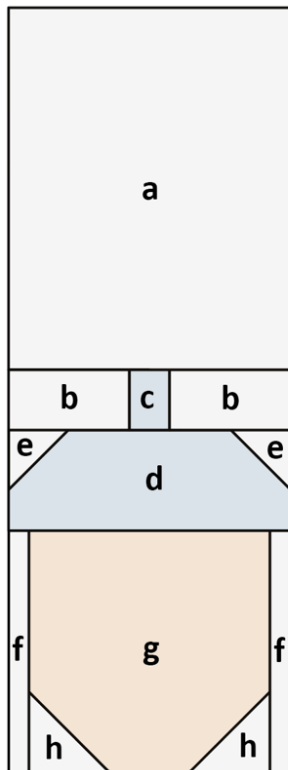

- a** 4in x 5in (10.2cm x 12.7cm)
- b** 2in x $1\frac{1}{4}$ in (5.1cm x 3.2cm)
- c** 1in x $1\frac{1}{4}$ in (2.5cm x 3.2cm)
- d** 4in x $1\frac{3}{4}$ in (10.2cm x 4.4cm)
- e** $1\frac{1}{4}$ in (3.2cm) square
- f** $\frac{3}{4}$ in x $3\frac{1}{2}$ in (2cm x 9cm)
- g** $3\frac{1}{2}$ in (9cm) square
- h** $1\frac{1}{2}$ in (3.8cm) square

Making the Blocks

7 Apart from the block assembly, most of the piecing is to make corner triangle units and the blocks use corner triangle units in various places. The basic technique is the same regardless of the size of the pieces being sewn. **Fig E** shows the stages of creating a corner triangle. **Fig F** shows where these units occur in the blocks (outlined in blue).

The basic process of sewing a corner triangle is as follows. Place the larger piece of fabric right side up (RS). Take the small square and pencil mark a diagonal line on the wrong side (WS) of the square. Pin the square right sides together with the larger fabric piece, aligning the edges as shown in **Fig E** and with the diagonal line in the direction needed. Sew along the marked line. Trim off excess fabric $\frac{1}{4}$ in (6mm) outside the sewn line and gently press the triangle outwards. Check the unit is the same size as the original larger piece of fabric, with no distortion.

Fig E Making a corner triangle unit

Fig F Units in the blocks needing corner triangles
(Outlined in blue)

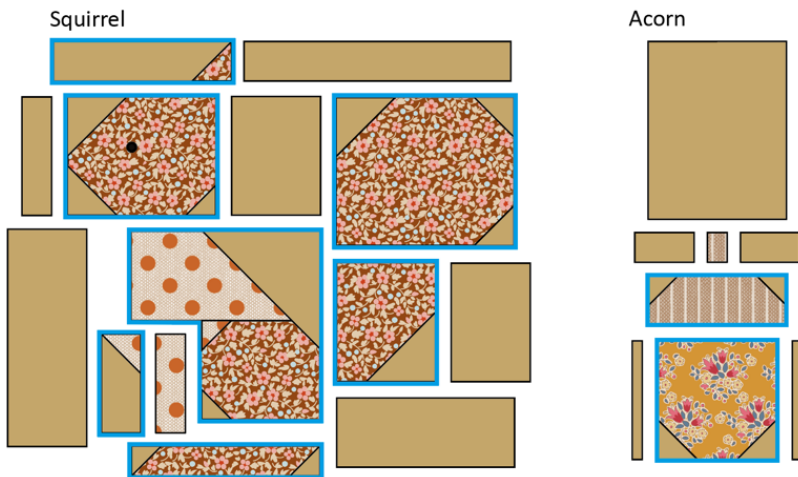

Making the Squirrel Block

8 When the pieced units have been made, a Squirrel block can be sewn together. Follow the stages shown in **Fig G**, pressing seams after each stage, pressing open or to one side. Note that in **Fig G 3**, a corner triangle needs to be created across the back of the squirrel, forming a triangle of Fabric 1 over the edges of piece **k** and piece **n**. When the assembly is finished, check the sewn block is 11¾in x 10in (29.8cm x 24.5cm). Use a French knot to sew the eye, using six strands of black stranded cotton, with the thread wrapped twice around the needle.

Fig G Assembling a Squirrel block

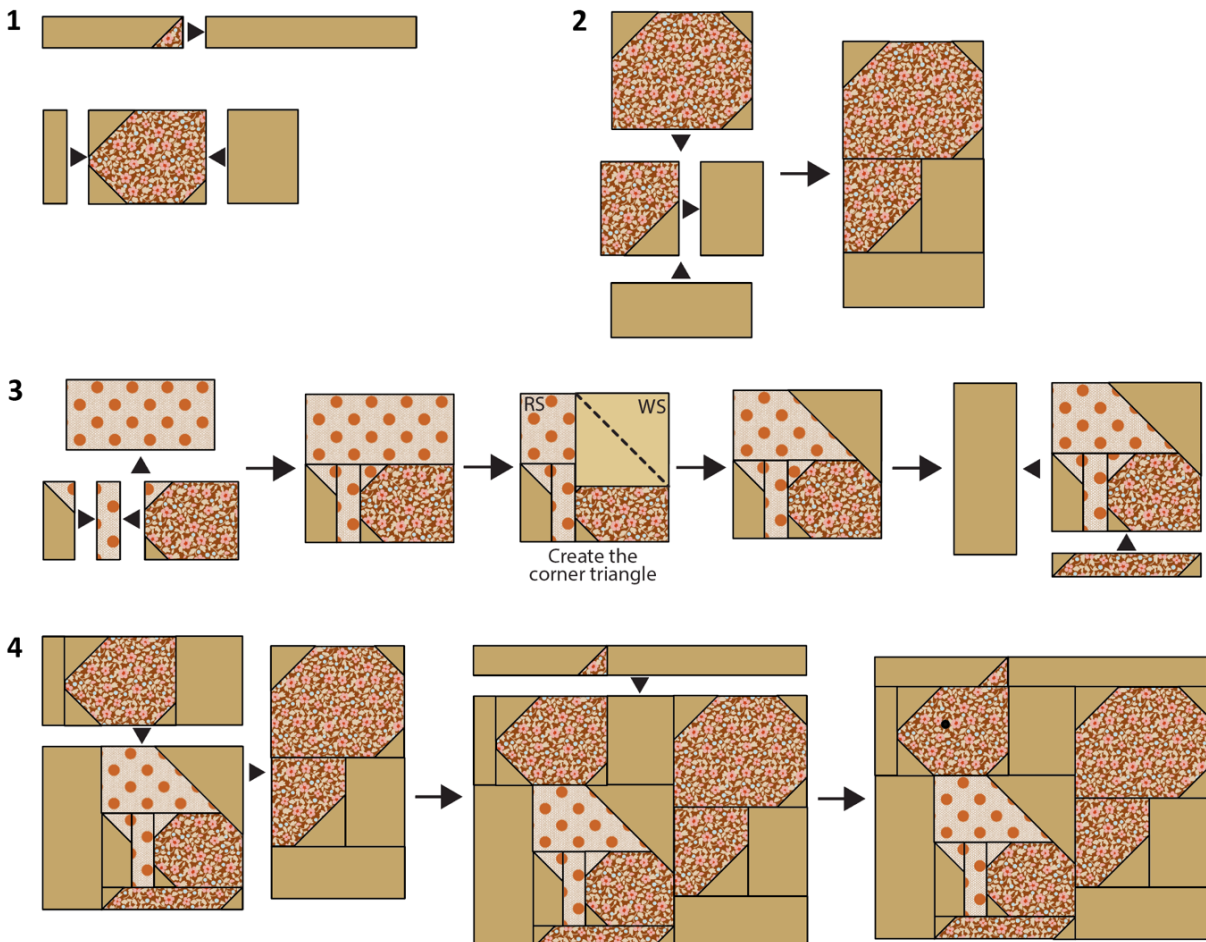

Making the Acorn Block

9 For the Acorn block, make the units that need corner triangles, as described before and then follow **Fig H** to sew the block together. Once sewn, check it is 4in x 10in (10.2cm x 25.4cm).

Fig H Assembling an Acorn block

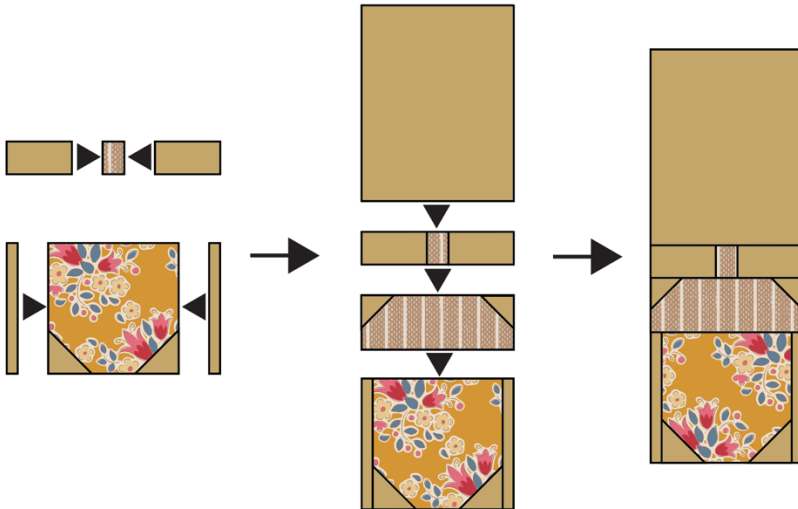

Assembling the Pillow

10 To complete the patchwork, sew the blocks together as in **Fig I**. Add the side borders to the patchwork, pressing seams out towards the border strips. Now add the top and bottom borders and press seams outwards.

Fig I Assembling the patchwork

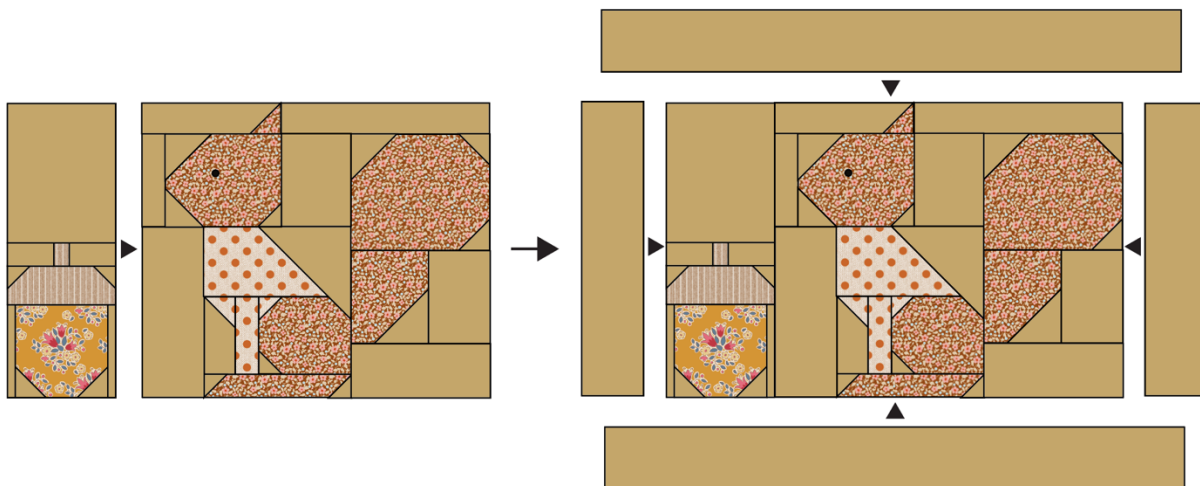

Quilting and Finishing

11 Make a quilt sandwich of the patchwork, wadding (batting) and lining fabric (if using). Quilt as desired. Trim off excess wadding and lining fabric to match the patchwork size.

12 To make up the pillow cover, take the two pieces of fabric for the cushion back and on one long edge of each piece, create a hem by turning the edge over by 1in (2.5cm), twice. Sew the seams with matching thread and press (**Fig J**). The diagram is shown in greys, so you can use the Tilda fabric and buttons suggested in the Materials list, or those of your choice.

13 For the fastening, using your sewing machine, create five equally spaced buttonholes within the hem of one of the pieces. Sew five buttons onto the other piece, matching their positions to the buttonholes. Note: Instead of making buttonholes, you could use a hook and loop fastening, such as Velcro, to fasten the cover and sew on the buttons as a decorative feature.

14 The pillow has a bound edge, so the pieces are assembled with right sides out, as follows. On the backing, fasten the buttons into the buttonholes and place the whole piece right side down. Place the quilted patchwork on top, right side up. Make sure the outer edges of all pieces are aligned. Pin or tack (baste) the layers together and then bind as normal. As you sew the binding in place it will fix the other layers together. Press the cover and insert a pillow pad to finish.

Fig J Making up the cover

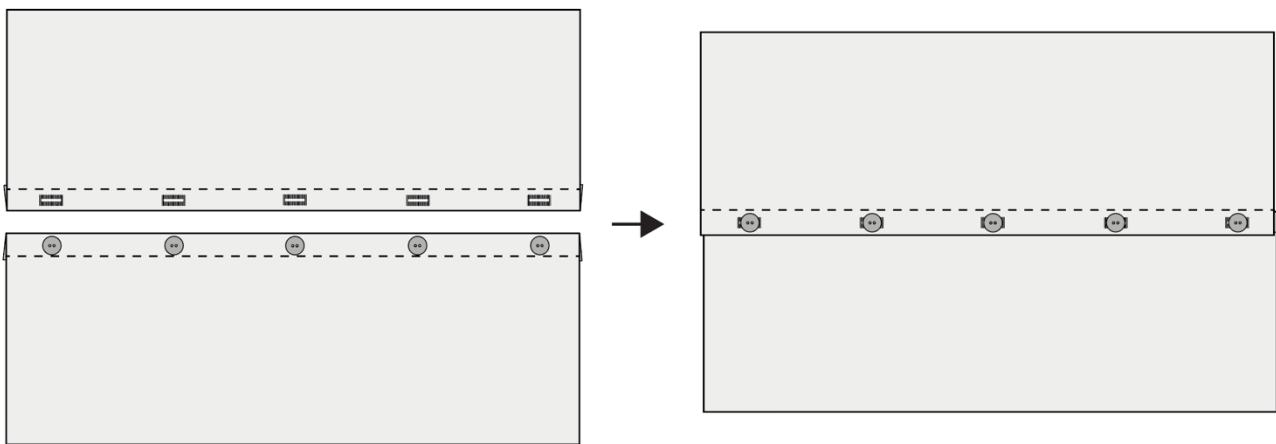

Tilda®
FABRICS